

## 2.0D FORMLOK® DOVETAIL DECK-SLAB ACOUSTICAL SOLUTIONS

**ACHIEVE QUIET SPACES WITH PREMIUM FINISHES BY USING THE  
SUPERIOR STC AND IIC RATINGS OF 2.0D FORMLOK DECK-SLABS**

### 2.0D FORMLOK DECK-SLAB

- 2" (51 mm) Deep Composite Deck
- 5½" (140 mm) Total Slab Depth
- Normal Weight Concrete (145 pcf / 2325 kg/m<sup>3</sup>)
- Exposed Deck Ceiling

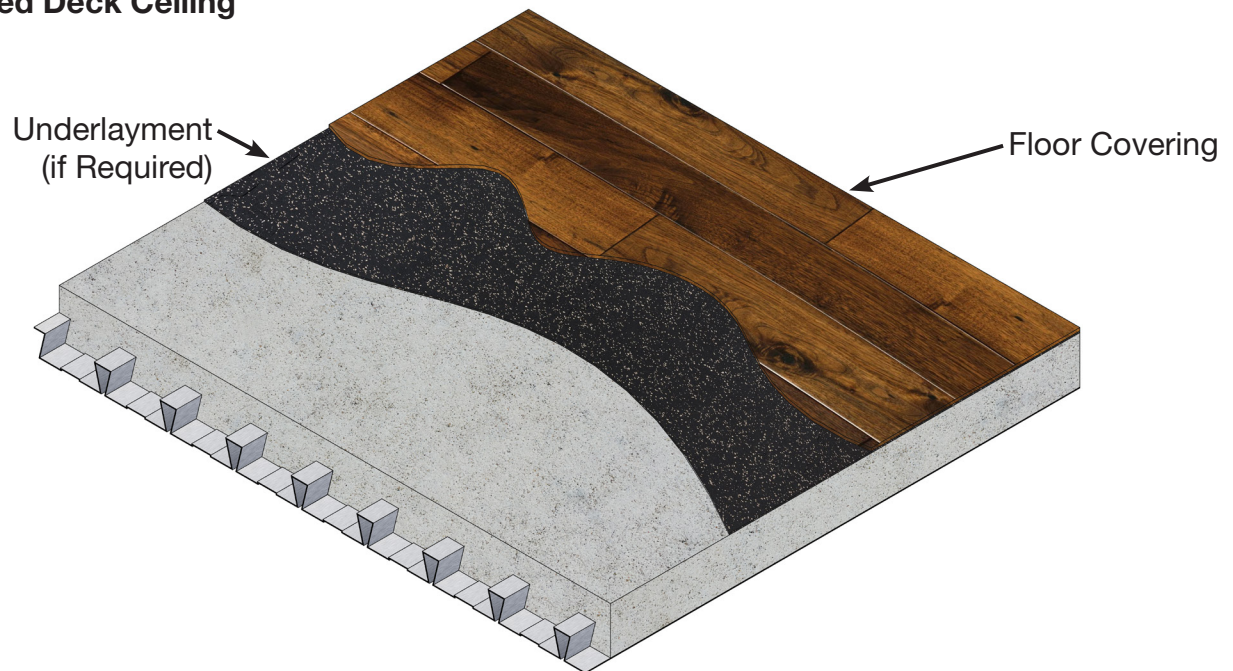

### Exposed Deck (No Ceiling)

Floor Covering	Underlayment	STC	IIC	Intertek Test No.
Ceramic Tile	5 mm ECOsilence	51	41	<a href="#">H7786.06</a>
Engineered Wood	5 mm ECOsilence	50	50	<a href="#">H7786.05</a>
Fusion Hybrid Vinyl Plank	2 mm ECOsilence	46	51	<a href="#">H7786.02</a>
Attain Luxury Vinyl Tile	5 mm ECOsilence	52	51	<a href="#">H7786.03</a>
Forest Rx Rubber Backed Sheet Vinyl	None	51	51	<a href="#">H7786.04</a>
Exposed Concrete	None	52	23	<a href="#">H7786.01</a>

# 2.0D FORMLOK® DOVETAIL DECK-SLAB ACOUSTICAL SOLUTIONS

## 2.0D FORMLOK DECK-SLAB

- 2" (51 mm) Deep Composite Deck
- 5½" (140 mm) Total Slab Depth
- Normal Weight Concrete (145 pcf / 2325 kg/m³)
- Gypsum Board Ceiling

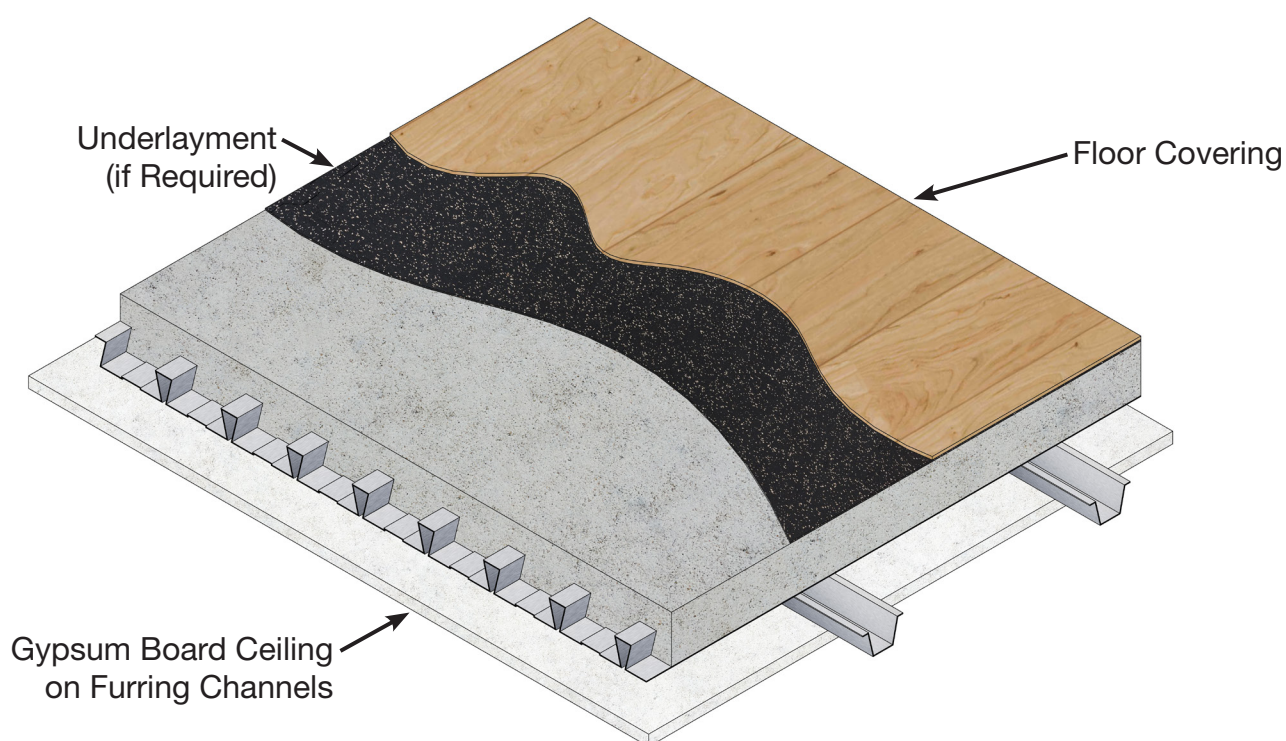

### Gypsum Board Ceiling on Furring Channels Directly Attached to Deck

Floor Covering	Underlayment	STC	IIC	Intertek Test No.
Ceramic Tile	5 mm ECOsilence	53	47	<a href="#">H7786.12</a>
Engineered Wood	5 mm ECOsilence	50	50	<a href="#">H7786.11</a>
Fusion Hybrid Vinyl Plank	2 mm ECOsilence	51	50	<a href="#">H7786.08</a>
Attain Luxury Vinyl Tile	2 mm ECOsilence	52	50	<a href="#">H7786.09</a>
Forest Rx Rubber Backed Sheet Vinyl	None	50	50	<a href="#">H7786.10</a>
Exposed Concrete	None	52	32	<a href="#">H7786.07</a>

#### Note:

1. Values shown are for gypsum board on furring channels directly connected to the underside of the slab. Gypsum board ceilings attached to the deck by methods providing acoustical separation will provide improved STC and IIC values.



## 2.0D FORMLOK® DOVETAIL DECK-SLAB ACOUSTICAL SOLUTIONS

### 2.0D FORMLOK DECK-SLAB

- 2" (51 mm) Deep Composite Deck
- 5½" (140 mm) Total Slab Depth
- Normal Weight Concrete (145 pcf / 2325 kg/m³)
- Suspended Gypsum Board Ceiling

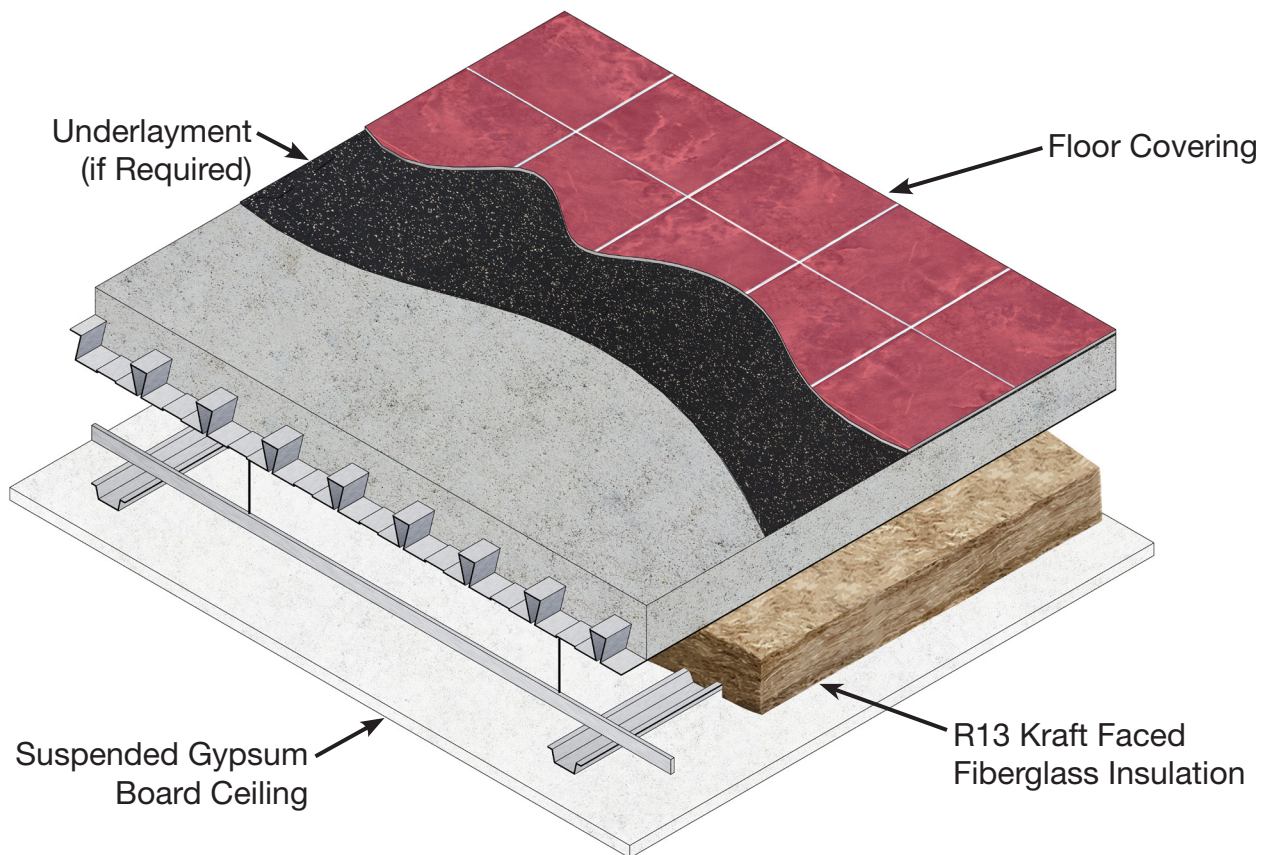

### Suspended Gypsum Board Ceiling

Floor Covering	Underlayment	STC	IIC	Intertek Test No.
Ceramic Tile	5 mm ECOsilence	62	60	<a href="#">I5133.01</a>

#### Note:

1. Laboratory tests determining STC and IIC for Dovetail FormLok deck with a suspended ceiling were conducted with ceramic tile and underlayment. Adding a suspended ceiling to the ceramic tile assembly improved the STC rating by 11 and the IIC rating by 19 compared to an assembly with no ceiling. Other flooring types can expect similar improvement in performance.

## 2.0D FORMLOK® DOVETAIL DECK-SLAB

### Notes:

1. The acoustical test reports with complete assembly details are available from [www.dovetaildeck.com](http://www.dovetaildeck.com).
2. The testing was performed in accordance with the following standards:
  - **ASTM E90-09 (2016)**, *Standard Test Method for Laboratory Measurement of Airborne Sound Transmission Loss of Building Partitions*
  - **ASTM E492-09(2016)e1**, *Standard Test Method for Laboratory Measurement of Impact Sound Transmission Through Floor-Ceiling Assemblies Using the Tapping Machine*

NOTICE: Design defects that could cause injury or death may result from relying on the information in this document without independent verification by a qualified professional. The information in this document is provided "AS IS". Nucor Corporation and its affiliates expressly disclaim: (i) any and all representations, warranties and conditions and (ii) all liability arising out of or related to this document and the information in it.