

3.5DF-24 DOVETAIL ROOF DECK GRADE 50 STEEL

Imperial
LSD

3.5DF-24 DOVETAIL ROOF DECK

- Enhanced 2-Coat Polyester Paint
- White Factory Primer Paint
- Galvanized Finish
- FM Listed

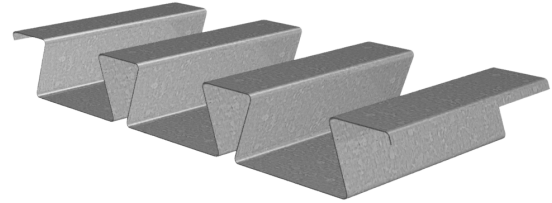

Nominal Dimensions

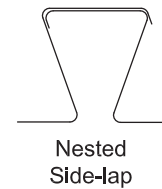
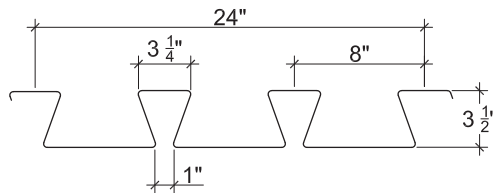

Section Properties

Deck Gage	Deck Weight w_{dd} (psf)	Base Metal Thickness t (in.)	Yield Strength F_y (ksi)	Effective Moment of Inertia at Service Load $I_d = (2I_e + I_o)/3$		Effective Section Modulus at $F_y = 50$ ksi		Factored Moment		Vertical Web Shear ϕV_n (lb/ft)
				I_{d+} (in ⁴ /ft)	I_{d-} (in ⁴ /ft)	S_{e+} (in ³ /ft)	S_{e-} (in ³ /ft)	ϕM_{n+} (lb-ft/ft)	ϕM_{n-} (lb-ft/ft)	
18	4.5	0.0478	50	2.688	2.496	1.055	0.935	3957	3507	8721
16	5.6	0.0598	50	3.430	3.256	1.417	1.289	5314	4835	12520

Factored Reactions at Supports Based on Web Crippling, ϕR_n (lb/ft)

Deck Gage	Bearing Length of Webs											
	One-Flange Loading					Two-Flange Loading						
	End Bearing				Interior Bearing		End Bearing				Interior Bearing	
	2"	3"	4"	5"	4"	6"	2"	3"	4"	5"	4"	6"
18	1992	2269	2502	2708	3850	4376	2006	2220	2400	2559	4650	5337
16	3015	3416	3754	4051	5794	6552	3232	3557	3831	4072	7102	8110

Standard Features

- ASTM A653/A653M SS GR50 Min., with Z275/G90 galvanized
- Standard lengths – 6'-0" to 40'-0"
- UL and FM Listed
- Cold-formed steel deck conforms to CAN/CSA S136-16 and meets the guidelines of CSSBI 10M-2018.

Optional Features

- Inquire regarding cost and lead times for:
 - 17 gage
 - Alternative metallic and painted finishes
- Perforated Acoustical Versions

3.5DF-24 DOVETAIL ROOF DECK GRADE 50 STEEL

Imperial
LSD

Inward Uniform Factored Loads, LSD (psf)

Deck Gage	Spans	Criteria	Span (ft-in.)										
			11'-0"	12'-0"	13'-0"	14'-0"	15'-0"	16'-0"	17'-0"	18'-0"	19'-0"	20'-0"	21'-0"
18	Single	ϕW_n	262	220	187	162	141	124	110	98	88	79	72
		L/240	132	102	80	64	52	43	36	30	26	22	19
	Double	ϕW_n	228	192	164	142	124	109	96	86	77	70	
		L/240	296	228	179	144	117	96	80	68	57	49	
	Triple	ϕW_n	283	239	204								
		L/240	232	179	141								
16	Single	ϕW_n	351	295	252	217	189	166	147	131	118	106	96
		L/240	169	130	102	82	67	55	46	39	33	28	24
	Double	ϕW_n	315	265	226	196	171	150	133	119	107	96	
		L/240	386	298	234	187	152	126	105	88	75	64	
	Triple	ϕW_n	391	330	282								
		L/240	303	233	183								

Note:

1. Table does not account for web crippling. Required bearing should be determined based on specific span conditions.

NOTICE: Design defects that could cause injury or death may result from relying on the information in this document without independent verification by a qualified professional. The information in this document is provided "AS IS". Nucor Corporation and its affiliates expressly disclaim: (i) any and all representations, warranties and conditions and (ii) all liability arising out of or related to this document and the information in it.